

OFFICE SPACE FOR LEASE

5300 BEE CAVE ROAD, BUILDING I

Availabilities:

Suite 100 — 4,793 RSF

Lease Rate: \$23/ SF (NNN)

Opex: \$9.27 RSF + electric

Parking: 4.17/1,000 sf



**MATHIAS
PARTNERS**

505 West 15th Street
Austin, Texas 78701
ph. (512) 330-9111
www.mathiaspartners.com

For information, please contact:

Jerry Smith
(512) 637-6953
jsmith@mathiaspartners.com

Matt Mathias
(512) 637-6951
matt@mathiaspartners.com

MEDICAL / PROFESSIONAL OFFICES IN PRESTIGIOUS WEST LAKE HILLS:

- **Easy access to Capital of Texas Hwy (Loop 360) & MoPac Expressway**
- **Close proximity (within 400 yards) of Westlake Hospital and Surgical Center**
- **Reserved Garage Parking Available**
- **First Floor Lobby Exposure**
- **On-Site Banking**
- **Hill Country Views**

The information contained herein has been obtained from sources deemed to be reliable; however, Mathias Partners makes no guarantees, warranties, or representations as to the accuracy thereof. All information is presented subject to changes in price, corrections, errors, omissions, prior sale, or withdrawal without notice.



Existing Floor Plan

Drawings are not to scale and dimensions are not guaranteed accurate

Suite 100 - 4,793 SF

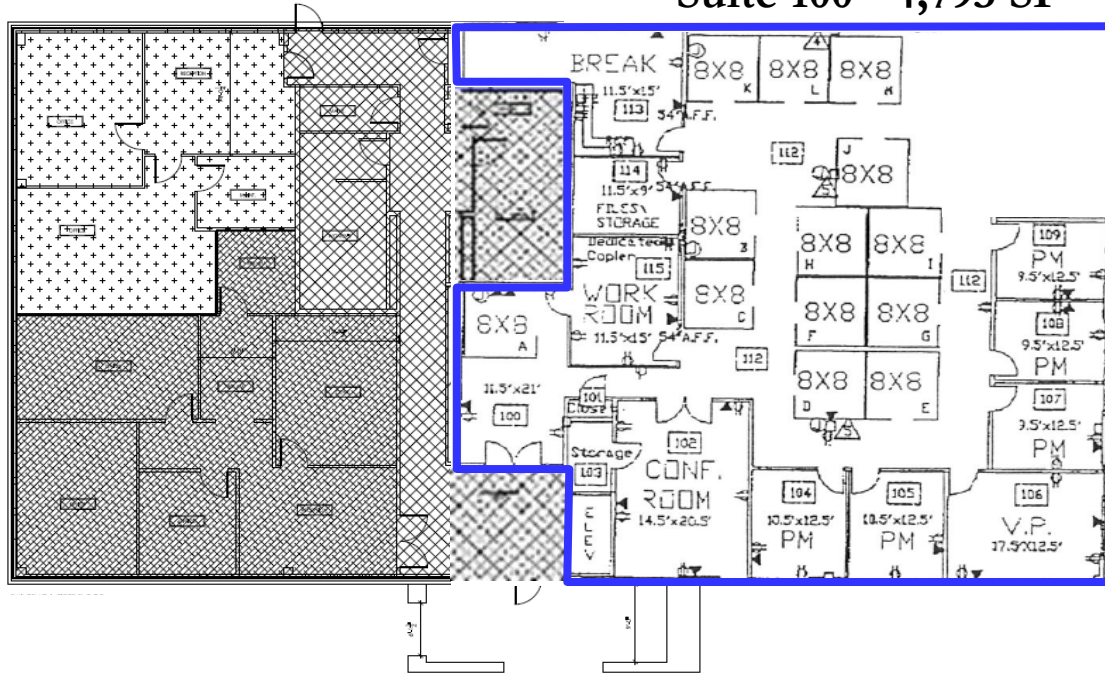

Location Map

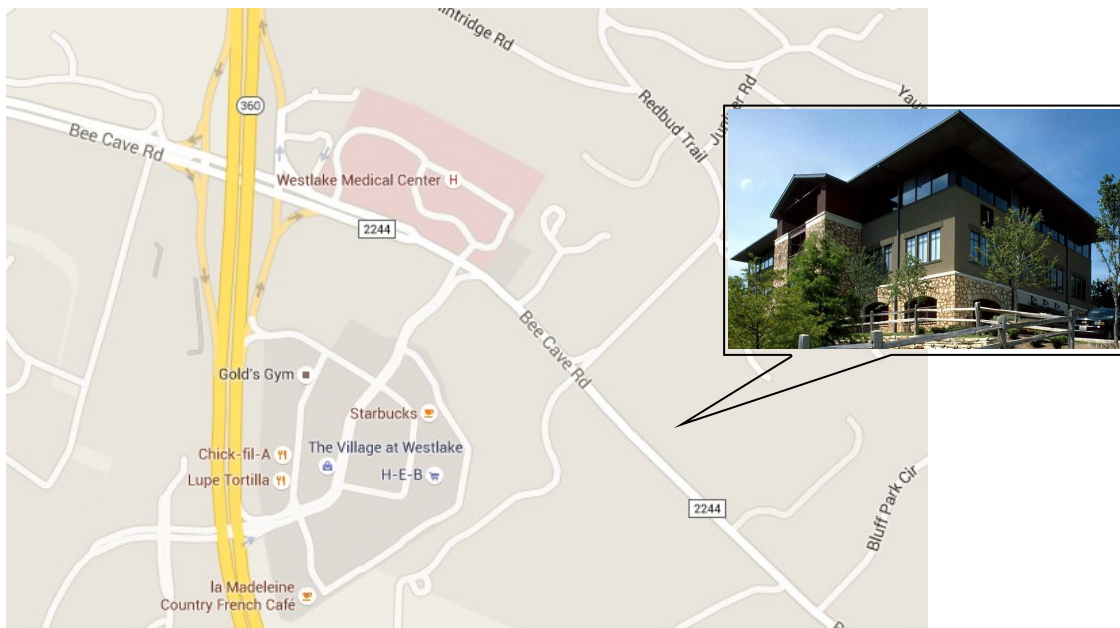

The information contained herein has been obtained from sources deemed to be reliable; however, Mathias Partners makes no guarantees, warranties, or representations as to the accuracy thereof. All information is presented subject to changes in price, corrections, errors, omissions, prior sale, or withdrawal without notice.



11-2-2015



Information About Brokerage Services

Texas law requires all real estate license holders to give the following information about brokerage services to prospective buyers, tenants, sellers and landlords.

TYPES OF REAL ESTATE LICENSE HOLDERS:

- A **BROKER** is responsible for all brokerage activities, including acts performed by sales agents sponsored by the broker.
- A **SALES AGENT** must be sponsored by a broker and works with clients on behalf of the broker.

A BROKER'S MINIMUM DUTIES REQUIRED BY LAW (A client is the person or party that the broker represents):

- Put the interests of the client above all others, including the broker's own interests;
- Inform the client of any material information about the property or transaction received by the broker;
- Answer the client's questions and present any offer to or counter-offer from the client; and
- Treat all parties to a real estate transaction honestly and fairly.

A LICENSE HOLDER CAN REPRESENT A PARTY IN A REAL ESTATE TRANSACTION:

AS AGENT FOR OWNER (SELLER/LANDLORD): The broker becomes the property owner's agent through an agreement with the owner, usually in a written listing to sell or property management agreement. An owner's agent must perform the broker's minimum duties above and must inform the owner of any material information about the property or transaction known by the agent, including information disclosed to the agent or subagent by the buyer or buyer's agent.

AS AGENT FOR BUYER/TENANT: The broker becomes the buyer/tenant's agent by agreeing to represent the buyer, usually through a written representation agreement. A buyer's agent must perform the broker's minimum duties above and must inform the buyer of any material information about the property or transaction known by the agent, including information disclosed to the agent by the seller or seller's agent.

AS AGENT FOR BOTH - INTERMEDIARY: To act as an intermediary between the parties the broker must first obtain the written agreement of *each party* to the transaction. The written agreement must state who will pay the broker and, in conspicuous bold or underlined print, set forth the broker's obligations as an intermediary. A broker who acts as an intermediary:

- Must treat all parties to the transaction impartially and fairly;
- May, with the parties' written consent, appoint a different license holder associated with the broker to each party (owner and buyer) to communicate with, provide opinions and advice to, and carry out the instructions of each party to the transaction.
- Must not, unless specifically authorized in writing to do so by the party, disclose:
 - that the owner will accept a price less than the written asking price;
 - that the buyer/tenant will pay a price greater than the price submitted in a written offer; and
 - any confidential information or any other information that a party specifically instructs the broker in writing not to disclose, unless required to do so by law.

AS SUBAGENT: A license holder acts as a subagent when aiding a buyer in a transaction without an agreement to represent the buyer. A subagent can assist the buyer but does not represent the buyer and must place the interests of the owner first.

TO AVOID DISPUTES, ALL AGREEMENTS BETWEEN YOU AND A BROKER SHOULD BE IN WRITING AND CLEARLY ESTABLISH:

- The broker's duties and responsibilities to you, and your obligations under the representation agreement.
- Who will pay the broker for services provided to you, when payment will be made and how the payment will be calculated.

LICENSE HOLDER CONTACT INFORMATION: This notice is being provided for information purposes. It does not create an obligation for you to use the broker's services. Please acknowledge receipt of this notice below and retain a copy for your records.

_____ Licensed Broker /Broker Firm Name or Primary Assumed Business Name	_____ License No.	_____ Email	_____ Phone
--	----------------------	----------------	----------------

_____ Designated Broker of Firm	_____ License No.	_____ Email	_____ Phone
------------------------------------	----------------------	----------------	----------------

_____ Licensed Supervisor of Sales Agent/ Associate	_____ License No.	_____ Email	_____ Phone
---	----------------------	----------------	----------------

_____ Sales Agent/Associate's Name	_____ License No.	_____ Email	_____ Phone
---------------------------------------	----------------------	----------------	----------------

Buyer/Tenant/Seller/Landlord Initials

Date